

			DWG. NO. 2650-1567-00				
REV.	ECO#	DESCRIPTION	DRAWN BY	DRAWN DATE	MECH. ENG.	ELEC. ENG.	DEPT. MGR.
1	20437	INITIAL RELEASE FOR NEW PART	AMS	04/20/11	MRG	-	MRG

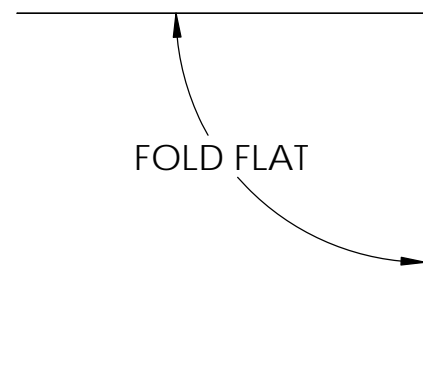
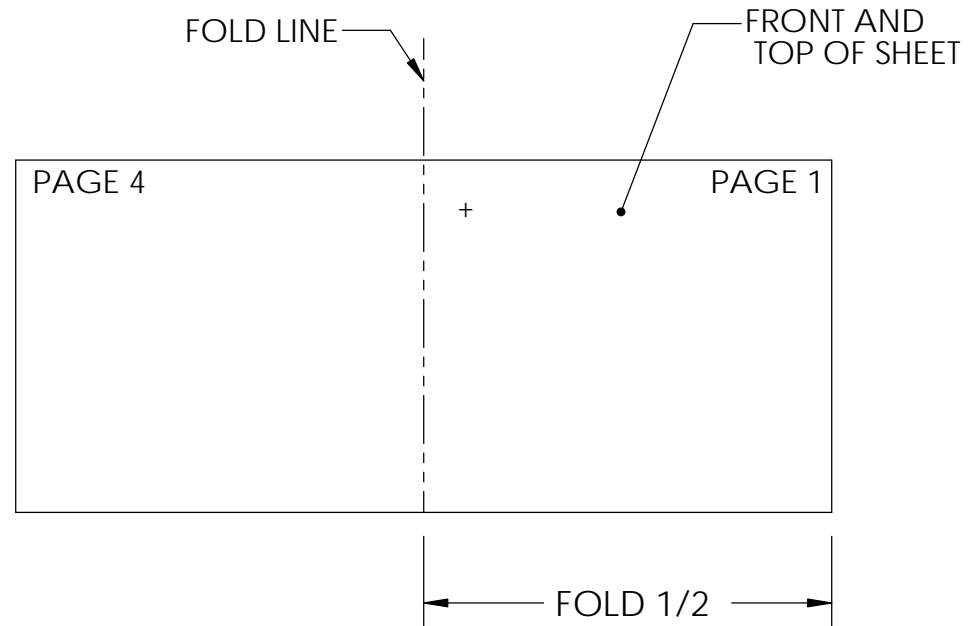

NOTES:

- 1) PRINT ON 11" x 17" PAPER DOUBLE-SIDED.
- 2) 5 MILS THICK LAMINATE 11.5" x 17.5"
- 3) SCORE AND FOLD INTO BOOKLET WITH PAGES IN NUMERICAL ORDER.
- 4) DRILL A .25" DIAMETER HOLE ON THE "+" MARK THROUGH ALL PAGES.
- 5) ARTWORK IMAGE ON THIS PRINT IS FOR REFERENCE USE ONLY. CONTACT AUTO METER FOR PRODUCTION ARTWORK.

未经本公司书面许可，任何单位及个人不得以任何方式或理由对上述产品、信息、材料的任何部分进行使用、复制、修改、抄录或传播。凡侵犯本公司版权等知识产权的，本公司必将依法追究其法律责任

DO NOT SCALE DRAWING C.A.D. GENERATED DRAWING THIS DOCUMENT HAS BEEN ISSUED FOR ENGINEERING INFORMATIONAL PURPOSES ONLY. ANY REVISIONS TO THE CONTENT OF THIS DOCUMENT MUST BE INCORPORATED INTO THE ORIGINAL CAD FILE. THIRD ANGLE PROJECTION 	UNLESS OTHERWISE SPECIFIED DIMENSIONS ARE IN INCHES. DIMENSIONS IN [] ARE MILLIMETERS. TOLERANCES ON: .X ± .02 [.508] .XX ± .010 [.254] .XXX ± .005 [.127] ANGULAR ± 0.5°	MATERIAL:	PRODUCTS, INCORPORATED 413 WEST ELM STREET SYCAMORE, ILLINOIS 60178
		FINISH:	
	THIS DRAWING CONTAINS PROPRIETARY INFORMATION AND SHALL NOT BE USED, REPRODUCED OR DISTRIBUTED WITHOUT THE PRIOR WRITTEN CONSENT OF AUTO METER PRODUCTS, INCORPORATED	TITLE: INSTRUCTION, QUICK REF GUIDE, BVA-200S	SCALE: NTS SHEET 1 OF 3
			2650-1567-00

REV.	ECO#	DESCRIPTION	DRAWN BY	DRAWN DATE	MECH. ENG.	ELEC. ENG.	DEPT. MGR.
1	-	See Sheet1	-	-	MRG	-	MRG

4

How to Use the Tester -Alternator Test-



WARNING: Safety glasses or goggles must be worn when using the tester.

1. It is recommended to perform all three tests (Battery, Starter, and Alternator). If continuing with the Alternator Test immediately after Starter Test, (you can leave the engine running), scroll down to the "Alternator Test" line & press **Y / Enter** Key



2. The Tester will automatically allow the voltage to stabilize before the test begins. Progress bar will indicate the tester is testing. (Be patient, it can take up to 30 seconds for the voltage to stabilize)



3. If the charging system tests good, the screen will appear.



4. High Regulation will damage the system. Replace or repair alternator.



5. If measured output is displayed the output may be low for some systems.



N If LCD reads "FAILED OUTPUT", It is recommended you test again with the engine at a faster idle (approx. 2000 RPM). If the test still reads "FAILED OUTPUT" Remove the Alternator and bench test it.



Auto Meter Products Inc.
413 West Elm St
Sycamore, IL 60178

Service (815) 899-0801
Toll Free (866) 883-TEST (8378)
www.autometer.com/test

2650-1567-00 4/14/11

+

BVA-200s Hand-Held Battery & System Analyzer

1



Caution: The grill on the BVA-200s may get hot after repeated use. Be sure to hold the unit from the side grips only. Keep hands away from the grill.

- Checks 6 and 12 volt batteries.
- Performs starting test and charging test on 12V systems.
- Unit uses a replaceable 9-volt alkaline battery to power LCD screen. Prompts when internal battery needs replacement.

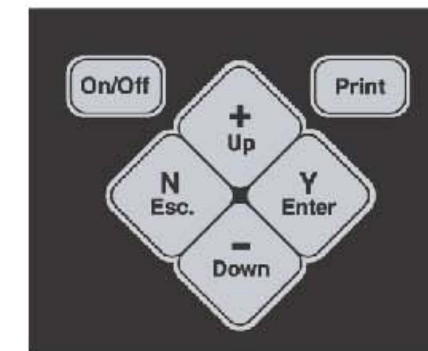

LCD Window Displays menus and test results *When a key is pressed the tester will beep*

On / Off Key	Manual On/Off key. The Display will show "Ready to Connect" when the unit is turned On.	Print Key	Prints test results to thermal printer.
Y / Enter Key	(1) Selects the next Menu (2) The cursor line item (3) The answer "Y" / Yes to a test progression.	+ / Up Key	(1) Moves the cursor up in order to select a menu line. (2) Increases certain display values.
N / Esc Key	(1) Cancels a test or progression. (2) Returns to the previous menu screen.	- / Down Key	(1) Moves the cursor down in order to select a menu line. (2) Decreases certain display values.

DO NOT SCALE DRAWING
C.A.D. GENERATED DRAWING
THIS DOCUMENT HAS BEEN ISSUED FOR ENGINEERING INFORMATIONAL PURPOSES ONLY. ANY REVISIONS TO THE CONTENT OF THIS DOCUMENT MUST BE INCORPORATED INTO THE ORIGINAL CAD FILE.

THIRD ANGLE PROJECTION

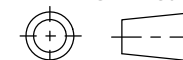

UNLESS OTHERWISE SPECIFIED DIMENSIONS ARE IN INCHES. DIMENSIONS IN [] ARE MILLIMETERS. TOLERANCES ON:
.X ± .02 [.508] .XX ± .010 [.254]
.XXX ± .005 [.127] ANGULAR ± 0.5°
THIS DRAWING CONTAINS PROPRIETARY INFORMATION AND SHALL NOT BE USED, REPRODUCED OR DISTRIBUTED WITHOUT THE PRIOR WRITTEN CONSENT OF AUTO METER PRODUCTS, INCORPORATED

MATERIAL:

FINISH:

TITLE:

INSTRUCTION, QUICK REF GUIDE, BVA-200S

Auto Meter

PRODUCTS, INCORPORATED
413 WEST ELM STREET
SYCAMORE, ILLINOIS 60178

SCALE: NTS SHEET 2 OF 3

2650-1567-00

REV.	ECO#	DESCRIPTION	DRAWN BY	DRAWN DATE	MECH. ENG.	ELEC. ENG.	DEPT. MGR.
1	-	See Sheet1	-	-	MRG	-	MRG

2

How to Use the Tester -Battery Test-



Connecting the Tester

1. Safety glasses or goggles must be worn when using the tester.
2. Press the On / Off Key
3. Connect the clamps to the battery: **Red clamp to (+) Positive battery post**
Black clamp to (-) Negative battery post

Performing a Battery Test

1. When the tester senses that it is connected to a battery it automatically defaults to a battery test and the menu prompt "Battery Temp" 70°F flashes.
2. If the battery test is what you want, press the Y / Enter key. (if the temperature is extremely different than 70°F - Use the Up / Down keys to change temperature then press the Y / Enter Key)
3. Enter the CCA rating for the battery. Use the + / Up and the - / Down keys to change the rating. Press Y / Enter key to continue once the rating has been entered.
4. Scroll down to choose type **Starting Standard** **Deep Cycle AGM** **Standard AGM** **Deep Cycle STD**
5. Confirm Inputs. If inputs are correct, Press 'Y' to continue. If changes are required, Press 'N' to re-enter battery information. Battery Test Begins...
6. Results are displayed

Good Battery	Battery is ready for service.	
Marginal Battery	Battery is good now but may not start the vehicle under extreme temperatures.	
Good Needs Charge	Battery good but needs to be charged by the store or customer before being returned to service.	
Charge and Retest	Battery did not have sufficient charge for a complete Load Test. Charge the battery then retest.	
Bad Battery	Replace battery.	

3

How to Use the Tester -Starter Testing-



Connecting the Tester

1. Safety glasses or goggles must be worn when using the tester.
2. Press the On / Off Key
3. Connect the clamps to the battery: **Red clamp to (+) Positive battery post**
Black clamp to (-) Negative battery post

Choosing a Starter Test

1. Use the + / Up and - / Down keys to select the desired test from the menu. Press the Y / Enter key to start the test.
 2. Start the Engine as Prompted / ***Note - The Starting System Test can only be completed if the Battery Test is good.**
 3. If current draw is between 75A and 250A (for gas engine), the starting system is likely good, this screen will appear.
 4. If current is under 75A, a solenoid connection or corrosion problem is likely & following screens appear.
- Check connections, cables at all contact points for corrosion or bad connection.
- If all connections are good, remove the starter and bench test.
- If current draw is over 251A, the system will need more information to determine if starting system is good. The next screen will ask what type of engine you are testing, Diesel or Gas.
- If engine is Diesel, the screens will prompt you to enter the number of cylinders.
- If Starting System is likely to have a problem, the screen will appear.
- Use the (+Up) and (-Down) keys to scroll through the screens. Press Y or N to go to main menu.
- If all connections are good, remove the starter and bench test it.
-
-
-
-
-
-
-

<p>DO NOT SCALE DRAWING C.A.D. GENERATED DRAWING</p> <p>THIS DOCUMENT HAS BEEN ISSUED FOR ENGINEERING INFORMATIONAL PURPOSES ONLY. ANY REVISIONS TO THE CONTENT OF THIS DOCUMENT MUST BE INCORPORATED INTO THE ORIGINAL CAD FILE.</p> <p>THIRD ANGLE PROJECTION</p>	<p>UNLESS OTHERWISE SPECIFIED DIMENSIONS ARE IN INCHES. DIMENSIONS IN [] ARE MILLIMETERS. TOLERANCES ON:</p> <p>.X ± .02 [.508] .XX ± .010 [.254]</p> <p>.XXX ± .005 [.127] ANGULAR ± 0.5°</p> <p>THIS DRAWING CONTAINS PROPRIETARY INFORMATION AND SHALL NOT BE USED, REPRODUCED OR DISTRIBUTED WITHOUT THE PRIOR WRITTEN CONSENT OF AUTO METER PRODUCTS, INCORPORATED</p>	MATERIAL:	<p>Auto Meter</p> <p>PRODUCTS, INCORPORATED</p> <p>413 WEST ELM STREET SYCAMORE, ILLINOIS 60178</p> <p>SCALE: NTS SHEET 3 OF 3</p> <p>2650-1567-00</p>
		FINISH:	